

NOTES

- PLASTIC EXTERIOR
- STAINLESS STEEL INTERIOR
- X6 BAG HOOKS SLIDE ALONG WIDTH FOR DIFFERENT BAG CONFIGURATIONS
- MAX LOAD **120KG**
- BUNDED AREA IN THE BASE TO CATCH SPILLS
- BUNDED AREA VOLUME **24L**
- REMOVE RUBBER BUNG TO DRAIN BUNDED AREA

CASTOR SPECIFICATION

- X2 SWIVEL BRAKE CASTORS
- X2 FIXED CASTORS
- STATIC LOAD CAPACITY PER CASTOR **375KG**
- LOAD CAPACITY PER CASTOR AT 4KM/H **150KG**
- WHEEL MATERIAL **NYLON/POLYAMIDE 6**
- CASTOR MATERIAL **304 STAINLESS STEEL**

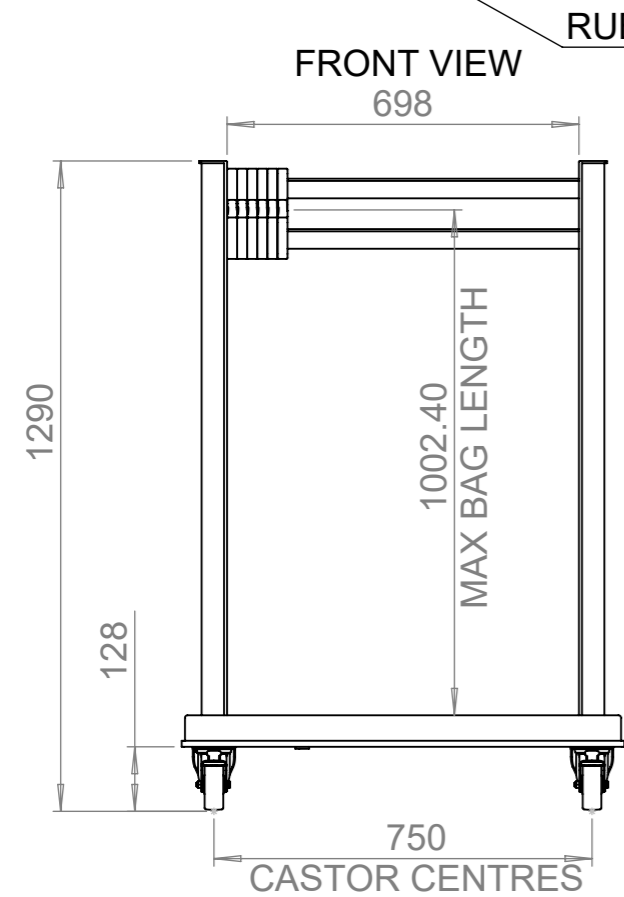
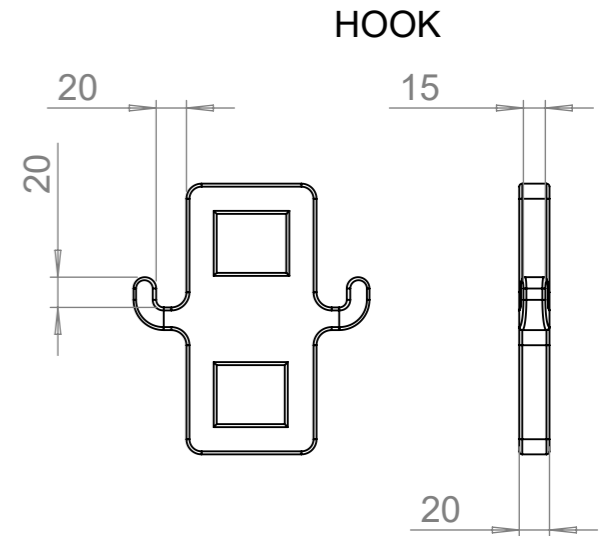

SIDE VIEW

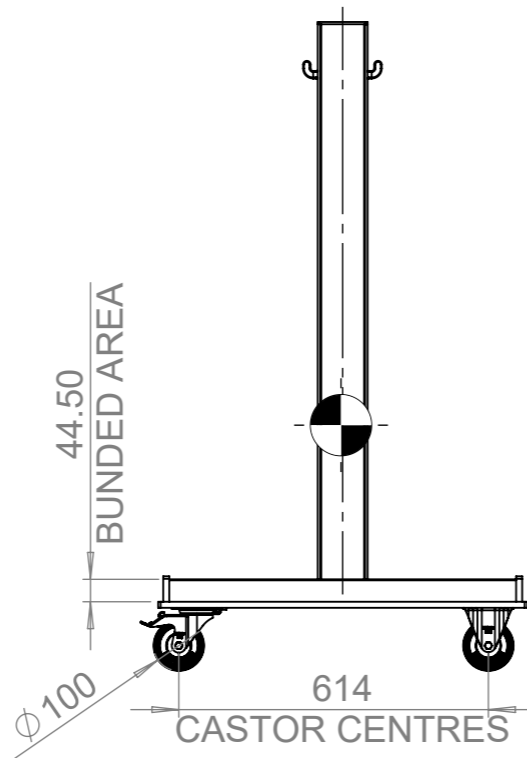

ISO VIEW
HOOKS BUNDLED ON ONE SIDE

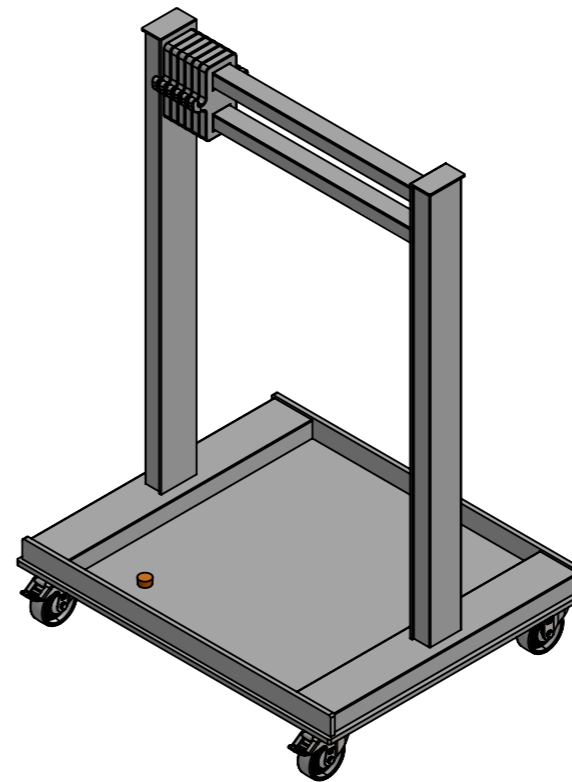

ISO VIEW
HOOKS SPACED EVENLY

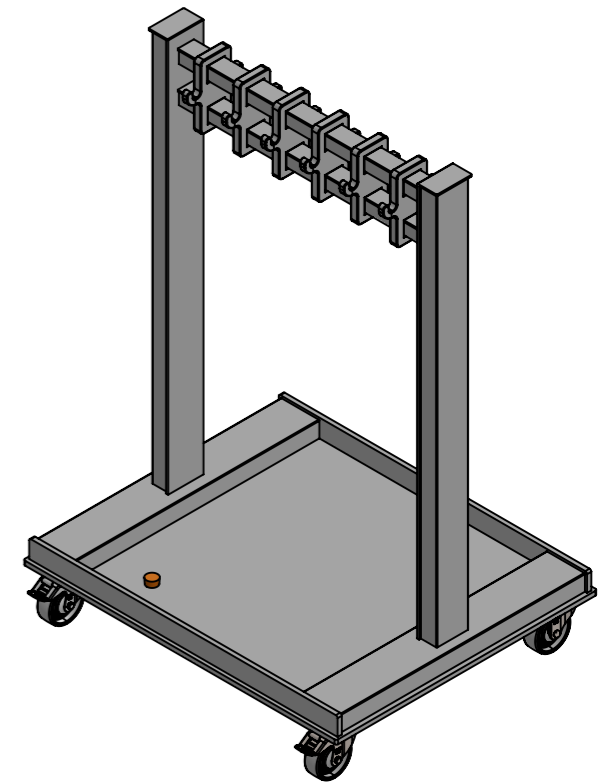

DO NOT SCALE DRAWING	DIMENSIONS ARE SHOWN IN MILLIMETRES	DEBURR AND BREAK SHARP EDGES	NAME	DATE
TEL +44(0)1472 800373	FAX +44(0)1472 730373	EMAIL - ENQUIRES@ALLPAQ.COM	DRAWN	AS 16/02/2023
WEB - WWW.ALLPAQ.COM	REGISTERED IN ENGLAND NO 6840689	VAT NUMBER 947939163	TECH	PS 20/02/2023
			PROD	JWC 20/02/2023
REV:	CHANGE NOTES:			
F2	Drawing template updated to V2	CB		22/01/2024
F3	Castor specification changed	JT		28/03/2024
F4	Drawing Template Updated to V3	CB		25/09/2024

DEFAULT TOLERANCES UNLESS STATED OTHERWISE				
GENERAL ASSEMBLY	< 500	± 3.00	> 500	± 1.00
FABRICATION	501 - 1000	± 5.00	1001 - 2000	± 3.00
	1001 - 2000	± 10.00	> 2001	± 5.00
	> 2001	± 15.00	> 2001	± 10.00
MACHINING	< 500	± 0.20	501 - 1000	± 0.40
	1001 - 2000	± 0.80	> 2001	± 1.50
MATERIAL: PP				
FINISH: SMOOTH				
WEIGHT: 32.70kg				

DO NOT SCALE DRAWING	SOURCE: AP	REVISION: F4
GENERAL ASSEMBLY		THIRD ANGLE PROJECTION
DESCRIPTION:		
2D Bag Stand		
DWG NO.	AP01CA0000S2-F4	A3
SCALE: 1:15	SHEET 1 OF 1	

ALLpaQ Packaging Group
Trusted Global Tote Solutions

ALLpaQ Packing Limited - Unit 4, albright Road, Widnes, Cheshire, WAG 8PY, UK.

THE INFORMATION CONTAINED IN THIS DRAWING IS THE SOLE PROPERTY OF ALLPAQ LTD. ANY REPRODUCTION IN PART OR AS A WHOLE WITHOUT THE WRITTEN PERMISSION OF ALLPAQ LTD IS PROHIBITED.

ALLPAQ LTD DO NOT IMPLY OR OFFER ANY RIGHTS TO COPY OUR IP ON THIS PRODUCT BY SUBMITTING THIS DRAWING. UNAUTHORISED DISTRIBUTION OF THIS INFORMATION IS STRICTLY FORBIDDEN. AND ANY CONSEQUENTIAL LOSSES SUFFERED WILL BE ACCEPTED BY THE RECIPIENT.