

CellScrew®

**Sustainable
and scalable
adherent cell
expansion
system**

HP HIGH PURITY
NEW ENGLAND



Large cell culture area formed by concentric cylinders

Easy handling through compact design

Excellent mixing and gas exchange through an Archimedean screw

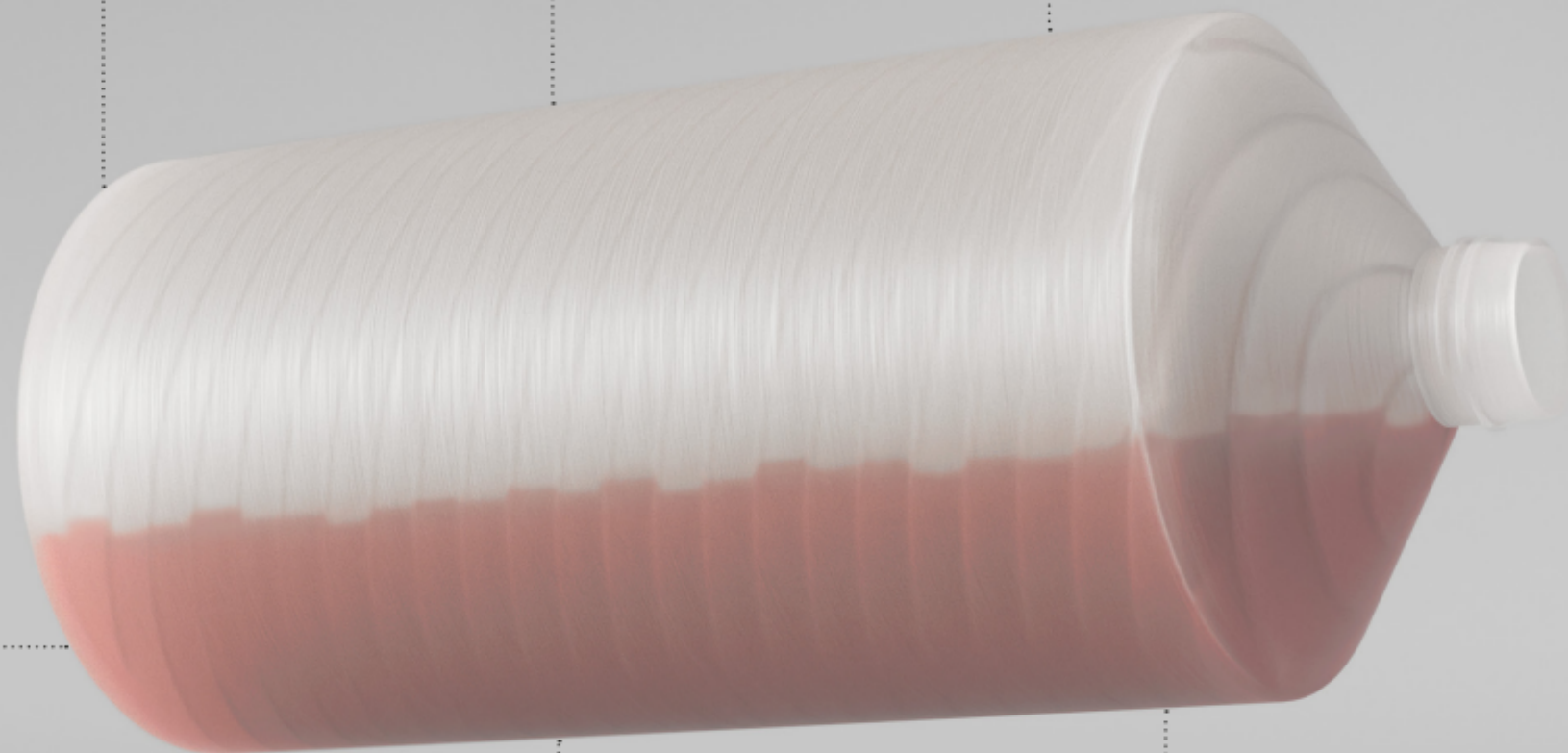

Extensive scalability options

Great automation potential

More sustainable than conventional multilayer flasks



Large growth area, low-shear mixing

The **CellScrew®** is a cell culture system designed for mass expansion of adherent cells. By rotation of the **CellScrew®**, media and gas are transferred through an Archimedean screw, providing an excellent environment for the cells.

Concentric cylinders form the large growth area. Due to TC-treatment, the surface is ideal for cell attachment and growth. The compact design allows easy handling and saves incubator space.



How it works

STEP 1 Inoculation

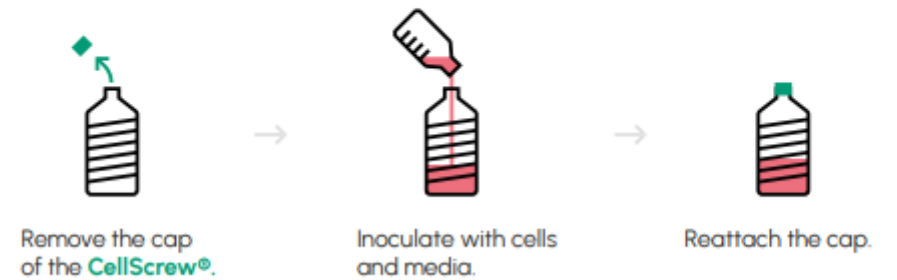

STEP 2 Incubation



STEP 3 Harvest

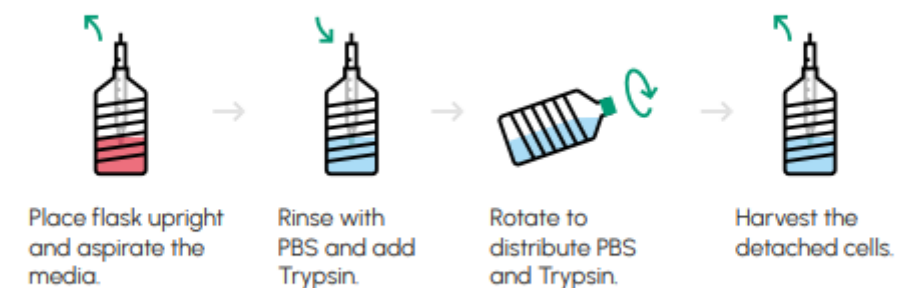

Dimensions

CS10K

Cell culture area: 10.000 cm²
Media volume: 450 - 1.300 mL

CS6K

Cell culture area: 6.000 cm²
Media volume: 250 - 800 mL

LEARN MORE



The world's most **sustainable** cell culture system made from **plant-based PLA**

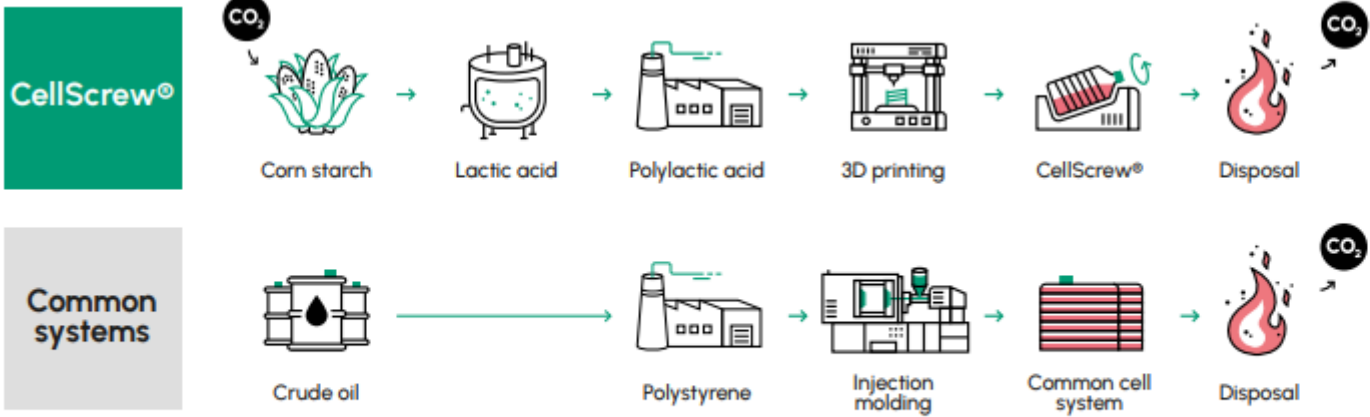

90% less plastic waste!

The additive manufacturing process allows us to make **more growth area** from **less raw material**.

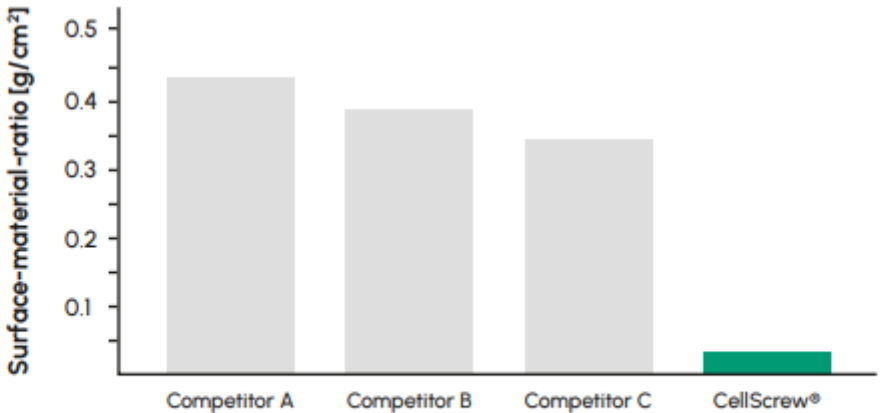

Your advantages with the CellScrew®

- ### Reduced manufacturing costs

The large growth area, intensified processes and ease of handling reduce **labour costs** and required **manufacturing space**.
- ### Reduced time to market

As the CellScrew® can be applied from lab scale to manufacturing scale, **no additional process development** is necessary to scale-up.
- ### Reduced environmental impact

Your **CO₂ emission** is reduced by more than **90%** using the CellScrew®, compared to conventional multilayer flasks.



info@hp-ne.com

+1.401.349.4477

www.hp-ne.com

